



01

Check the included items

As soon as you open the package, check to see that all items are included. If anything is missing, please contact your dealer.

* This package does not include a kick pedal, and a hi-hat stand. Use with a commercially available kick pedal, hi-hat stand, and snare stand.

MDS-Compact

* For the items included with the stand (MDS-Compact), refer to the owner's manual when checking that all items are included.



- Setup Guide (this document)
- Owner's manual set
- Drum key

02

Assemble the stand

* The tip of the mount is sharp. Handle it with care.

* When setting up or storing the stand, be careful not to pinch the fingers you use to handle the stand.

Assembly procedure

Assemble the stand (MDS-Compact) as type B (for ride cymbal) following the procedure described in the owner's manual.

Loosen this hand knob, and rotate the mount holder (L) 90 degrees in the direction of the arrow.

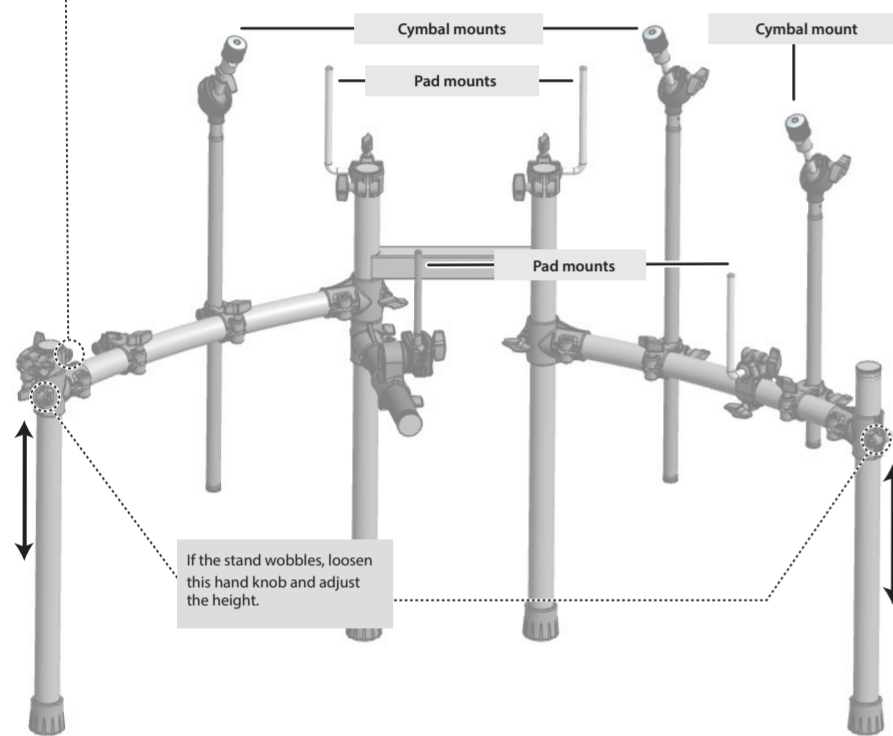
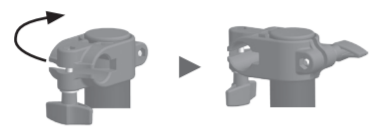

* For reasons of safety, do not spread the stand wider than 1.2 meters (47 inches).

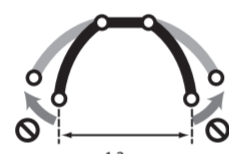

03

Attach the parts

Attach the hi-hat (VH-10)

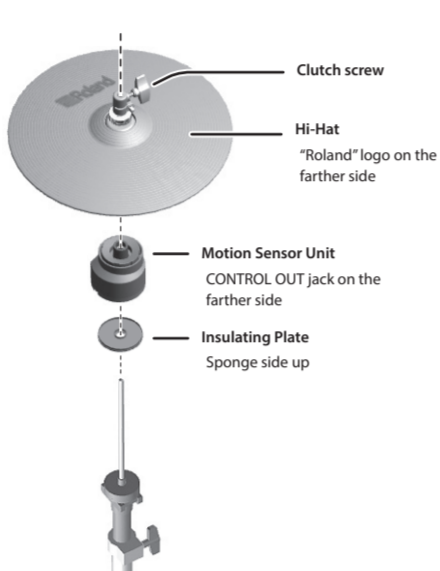

Compatible hi-hat stand

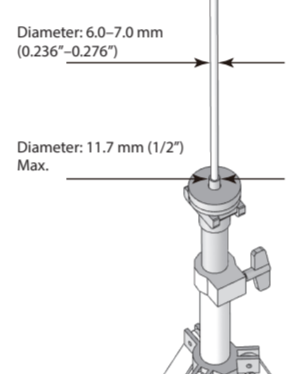

Attach the TD

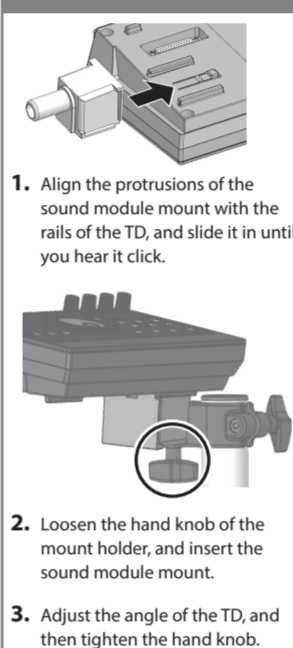

Attach the crash cymbal (CY-12C-T) and ride cymbal (CY-14R-T)

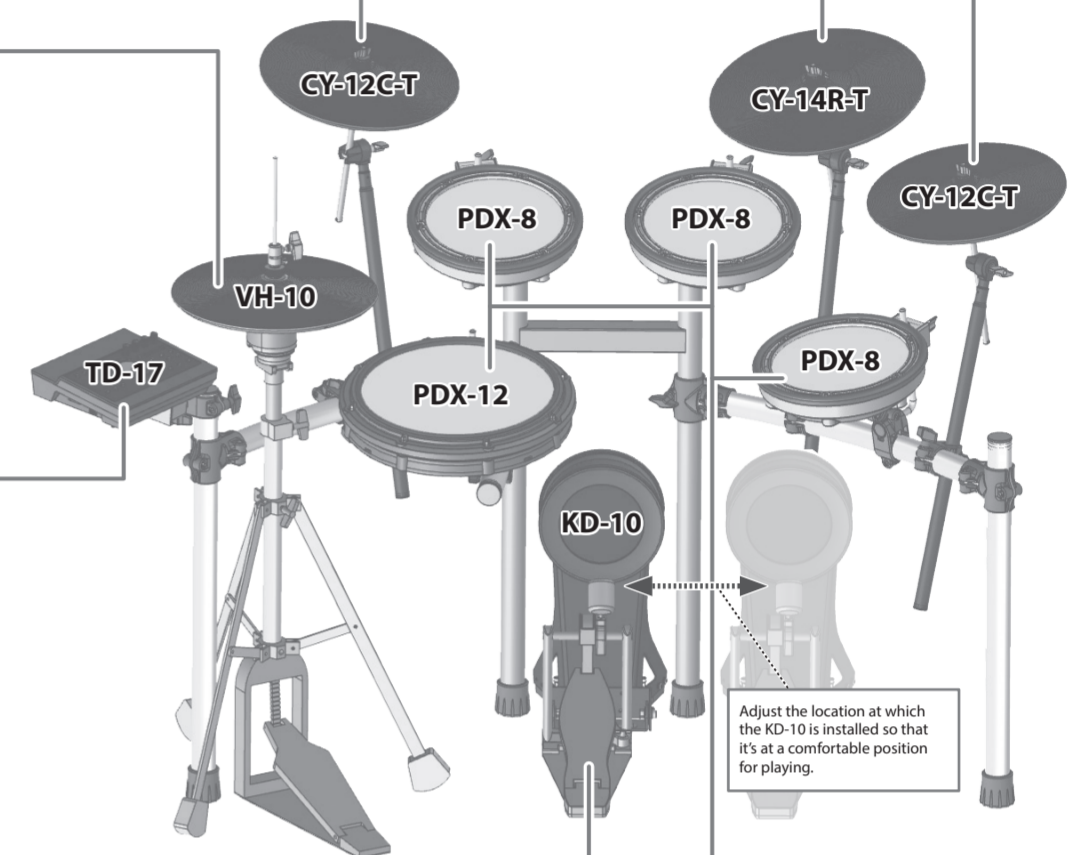
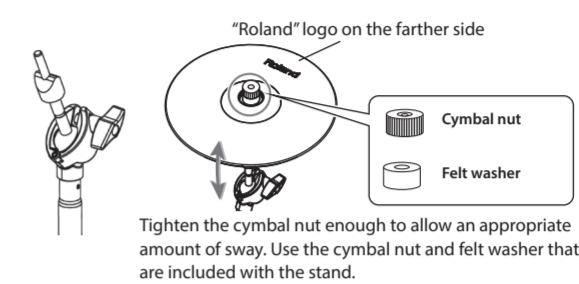

Attach the kick pedal (KD-10)

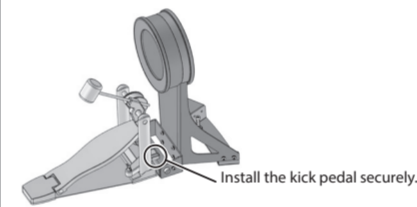

Attach the snare (PDX-12) and toms (PDX-8)

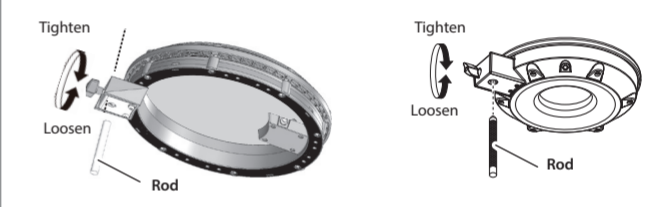

Adjusting the position of the cymbal

Adjust the height of the rod so that the highest point of the cymbal is less than 1.2 meters.

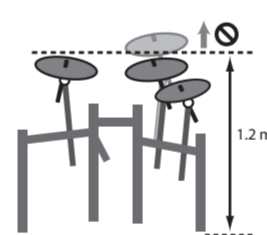

Attach the cymbal so that its center does not extend toward the back beyond the pipes of the stand (the pipes at the back of the stand).

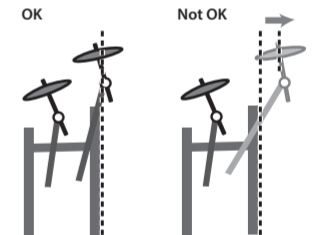

04

Connect the pads to TD

Connection procedure

- Connect the cable to TD as shown in the illustration. Insert the connector all the way, then turn the knobs to fasten it securely.
- Labels indicating the pad to be connected are attached to the cable. Connect the cable to the OUTPUT jack of each pad as shown in the illustration.
- Using the included trigger cable, connect crash cymbal 2 to the TD's CRASH 2 jack.

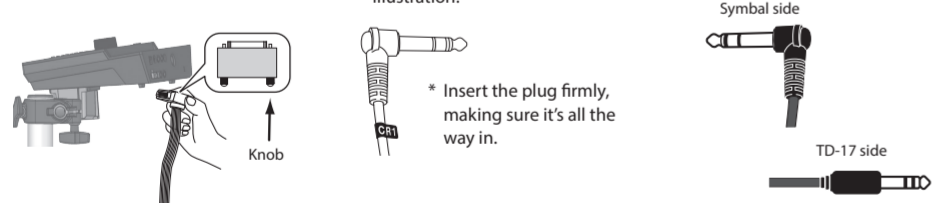

* Fasten the cables so that they will not obstruct your playing; use cable clips and cable ties. Make sure to wrap the cable ties around the pipes.

As seen from the back

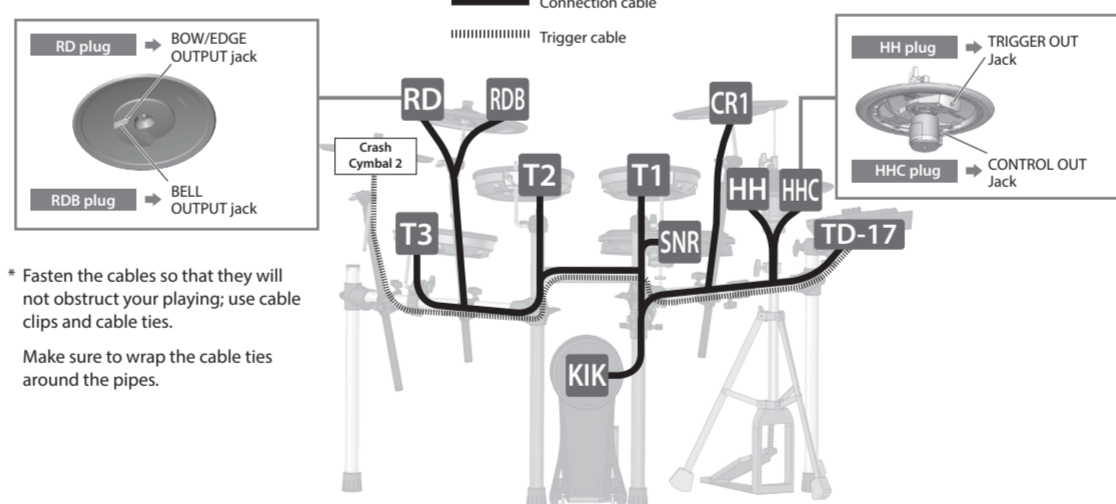

05

Connect the AC adaptor and speakers

Connect the AC adaptor, speakers, or headphones as described in the owner's manual of the TD.

* To prevent malfunction and equipment failure, always turn down the volume, and turn off all the units before making any connections.

Attaching the TD to a different location

You can change the location at which the TD is attached, so that the hi-hat stand is on the outside as shown in the illustration.

- Position the sound module mount as shown in the illustration below, and attach it to the TD.

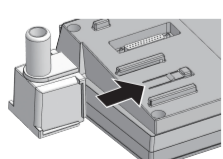

- Of the mount holders of curved pipe (L), insert the sound module mount into the mount holder to which the cymbal mount is not attached.

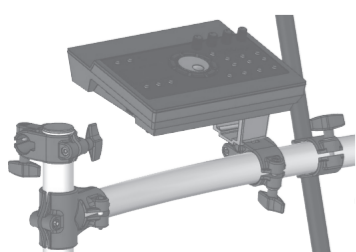

For a left-handed setup

The setup described in this guide is for right-handed players. To set up for a left-handed player, reattach the components as follows.

- Exchange curved pipes (L) and (R), and straight pipes (L) and (R), left-for-right.
- Attach holder (C) and the snare pipe to the right side.
- Exchange the pads and cymbals with their attachment mounts left-for-right.
- Exchange the TD with its sound module mount left-for-right.

Connect the cables as shown in the illustration.

As seen from the back

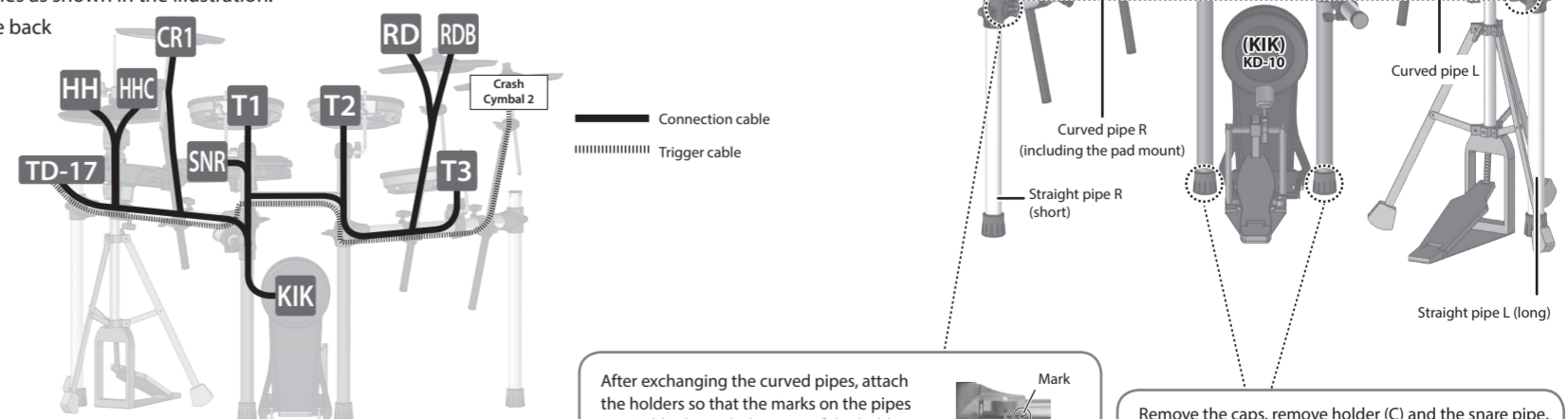

After exchanging the curved pipes, attach the holders so that the marks on the pipes are visible through the gaps of the holders.



Remove the caps, remove holder (C) and the snare pipe, and reattach them to the right side.

This completes assembly and connections.

■ When you've finished making connections, turn on the power as described in the TD-17/17-L Owner's Manual, and verify that you can hear sound.

Detailed explanation of each part

Adjust the VH-10

When using the VH-10, be sure to adjust the offset on the TD after connection.

This adjustment is required in order to correctly detect open, close, and pedal operations.

01 Adjust the offset.

1. After making the hi-hat settings, release your foot from the pedal, and while keeping your foot off the pedal, turn on the power of the TD.
2. Loosen the clutch screw and let the hi-hat rest naturally on the motion sensor unit.
3. Press the [SETUP] button.
4. Use the dial to select the "Hi-Hat Settings," and press the [ENTER] button.
5. Turn the dial to set the Pad Type to "VH10."
6. While watching the meter that's shown in the right of the screen, make adjustments by turning the VH offset adjustment screw of the VH-10.

Adjust the offset so that the appear in the meter.

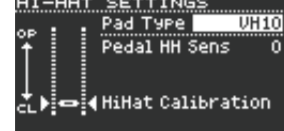

7. Press the [DRUM KIT] button to return the KIT screen.

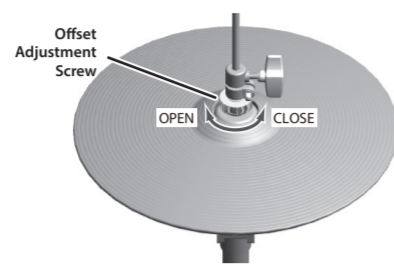

If you find the closed hi-hat sound difficult to play, turn the VH offset adjustment screw toward "CLOSE."
If you find the open hi-hat sound difficult to play, turn it toward "OPEN."
* If the sound is interrupted when you play a strong strike, adjust the VH offset adjustment screw toward "OPEN."

02 Adjust the hi-hat.

1. Make adjustments so that the cosmetic part in the lower middle of the hi-hat is 3 mm away from the center tip of the sensor, and then tighten the clutch screw.

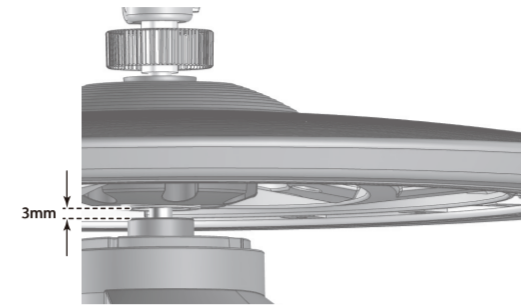

* The spacing can be adjusted to the distance that you find comfortable for playing, but if it is too narrow or too wide, malfunctions may occur, and you might not be able to play as expected.
3 mm is the spacing at which you'll be able to play the VH-10 with the most natural feel.

2. Use the hi-hat stand to adjust the tension of the pedal spring.

* Depending on the stand, it might not be possible to make adjustments.

NOTE

The hi-hat has a correct orientation. You'll obtain the optimal sensitivity if the "Roland" logo is toward the back as seen from the performer.

Fixing the cables

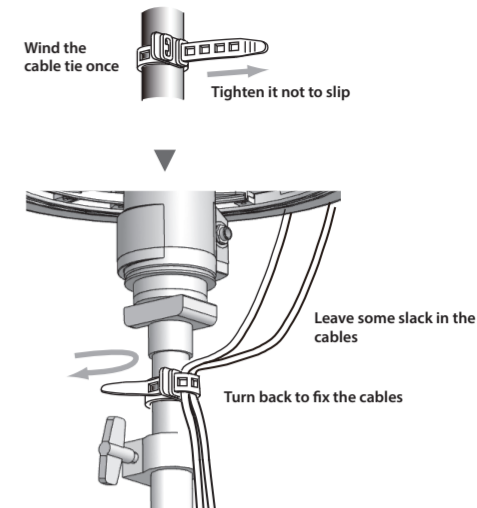

NOTE

* Continuous playing may cause dis-coloration of the pad, but this will not affect the Pad's function.

* If the hi-hat clutch has been detached from the hi-hat, refer to "If the Clutch Was Apart from the Hi-Hat" in the owner's manual.

KD-10 (Kick)

01 Attach the kick pedal.

Position the beater so that it strikes the center of the head, then secure the kick pedal and KD-10 firmly in place.

* A variety of commercially available beaters can be used, including felt, plastic, or wood types. However if a felt beater is used, the felt may leave marks on the striking surface.

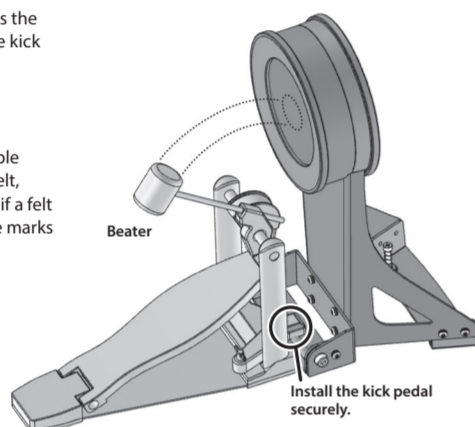

When Using a Twin Pedal

Position the two beaters equally apart from the center of the pad as shown in the figure at left. If one of the beater is further away from the center than the other, the sound from the further beater will be lower in volume, or will not sound as desired.

If you're using twin pedals, the sensitivity will be lower than when a single pedal is used. Raise the sensitivity on the sound module.

For details, refer to the TD's owner's manual.

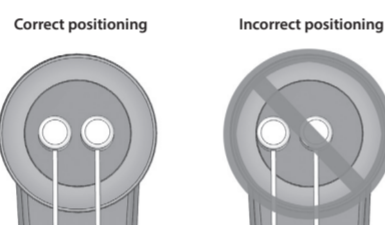

02 Step on the kick pedal and make sure that it's properly attached and in a stable position.

Check to make sure that the base of the KD-10 and the kick pedal both make contact with the floor.

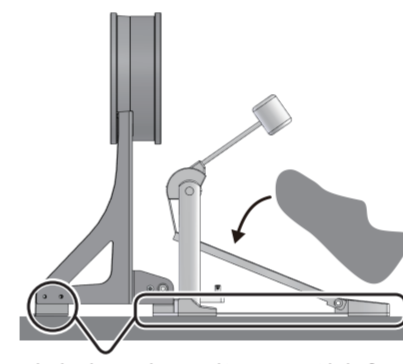

NOTE

- * Attach the KD-10 and the kick pedal securely.
- * Take care not to pinch your fingers.
- * Depending on how you're using the unit, the bolts that attach the pedal to the plate could become loose, causing the pedal to rattle during performance. In such cases, use commercially available tools to tighten the bolts.

03 Adjusting the Anchor Bolts.

If you're using this unit on a V-Drums mat, on a noise eater (NE-10), or on carpet, extending the anchor bolts will secure the unit in place.

However, if that's not enough to keep the KD-10 in a fixed position, you can adjust things so that the tips of the anchor bolts protrude through the base. That should keep it in place and make it easier for you to play.

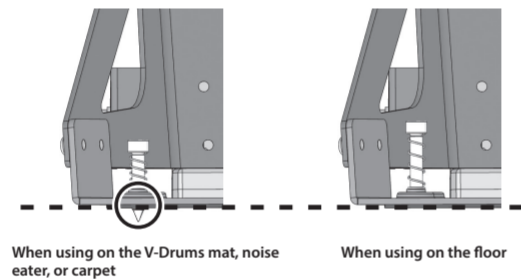

NOTE

- * When used on flooring, the anchor bolts may damage the floor. Adjust the anchor bolts correctly.
- * The tips of the anchor bolts are sharp. Handle with care.

Component names

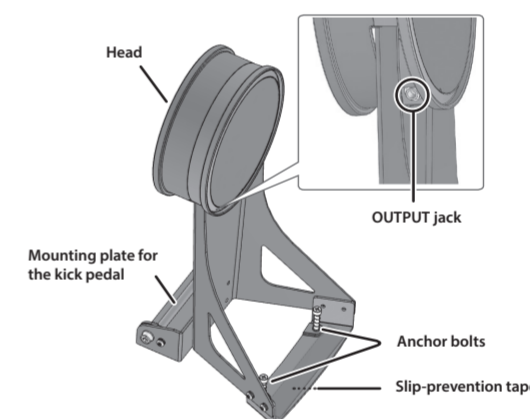

PDX-12 (Snare)

Component names

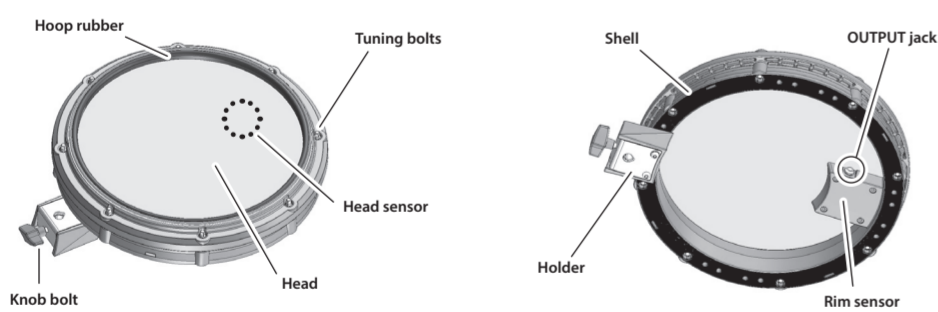

Adjusting the head tension

When the unit is shipped from the factory, this is adjusted fairly loosely. Before use, adjust the head to a fairly high tension.

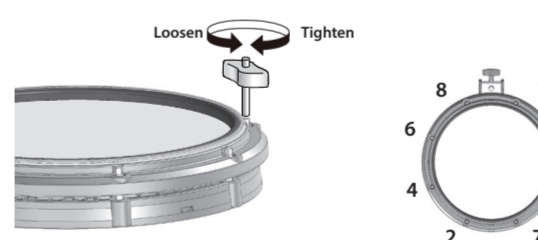

1. Adjust each tuning bolt a little at a time, moving in order from one side to the opposite side as shown in the illustration.
2. Fine-tune the adjustment while continuing to check the pad feel and response.

* Do not firmly tighten a single tuning bolt by itself. Doing so will make it impossible to tension the head evenly, and will cause malfunctions.

PDX-8 (Tom)

Component names

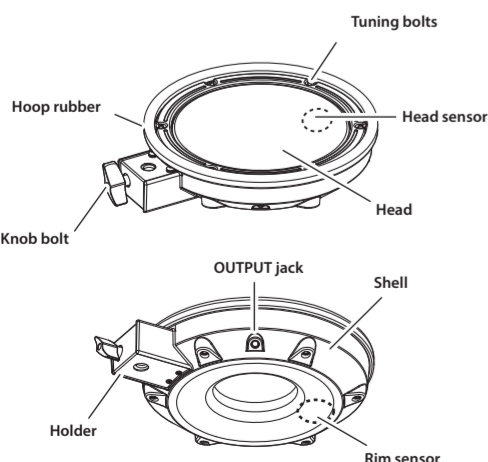

NOTE

Be sure to adjust the head tension of the pad before use.

Adjusting the head tension

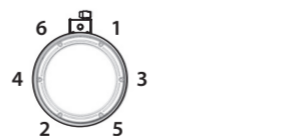

1. Adjust each tuning bolt a little at a time, moving in order from one side to the opposite side as shown in the illustration. The appropriate amount of tension is one that will provide approximately the same striking response as on an acoustic drum.

2. Use the drum key to adjust the tension as needed.

CY-12C-T (Crash)

CY-12C-T component names

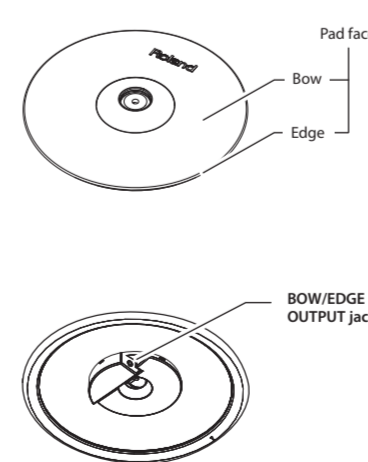

CY-14R-T (Ride)

CY-14R-T component names

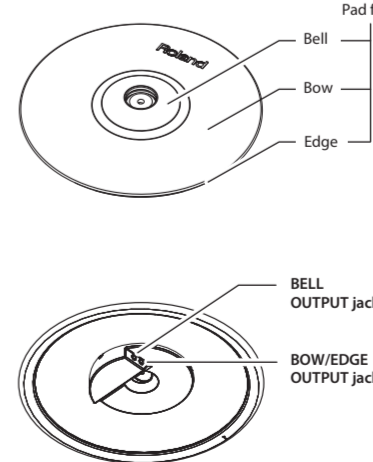

Fixing the cables (CY-14R-T/CY-12C-T)

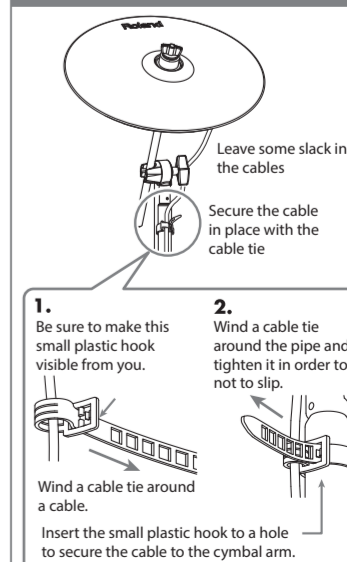

NOTE

Continuous playing may cause dis-coloration of the pad, but this will not affect the Pad's function.