



NOVA3

Beautiful Design. Beautiful Sound.

Out of this world versatility. This Space Series multi-pattern microphone fuses vintage sounding clarity and warmth with bold intergalactic design and ultimate flexibility.



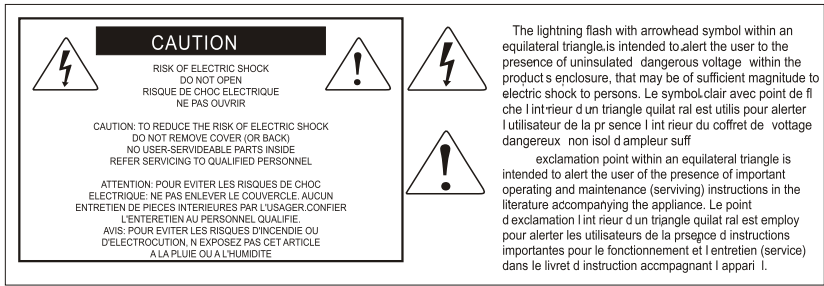

Important Safety Instructions

1. Read this manual thoroughly before using this unit.
2. Keep this manual for future reference.
3. Take notice of and comply with all warnings included in the user's manual or indicated on the appliance.
4. Follow all instructions included in this manual.
5. Do not expose this unit to rain or moisture. Avoid having water or other liquids spilled on this unit.
6. Do not block any ventilation openings or interfere with the proper ventilation of this unit. Install in accordance with the manufacturer's instructions.
7. Do not use or store near any heat sources such as radiators, heat registers, stoves, or other heat-producing appliances.
8. To avoid the risk of electrical shock, do not touch any exposed wiring while the unit is in operation.
9. Only use attachments/accessories specified by the manufacturer.
10. Unplug this unit and all connected electrical equipment during lightning storms or when left unused a long period of time.
11. Refer all servicing to qualified service personnel. Servicing is required when the appliance has been damaged in any way or fails to operate normally.

WARNING: To reduce the risk of fire or electric shock, do not expose this unit to rain or moisture

Contents

Introduction.....	4
What's in the package?	4
Register your ICON ProAudio product to your personal account.....	5
Features	6
Operating the Nova3	7
Specifications	10
Services.....	12

Introduction

Firstly, congratulations on your purchase of the ICON Pro Audio Nova3 Studio condenser microphone! In these pages, you'll find a detailed description of the features of the Nova3 Studio condenser microphone and a full list of specifications.

Please register the product on our website at the link below
[www. iconproaudio.com/registration](http://www.iconproaudio.com/registration):

As with most electronic devices, we strongly recommend you retain the original packaging. In the unlikely event that the product is returned for servicing, the original packaging (or reasonable equivalent) is required. With proper care and adequate air circulation, your Nova3 Studio condenser microphone will operate flawlessly for many years to come.

We trust that this product will provide years of excellent service and in the unlikely event that your product does not perform to the highest standard, every effort will be made to address the issue.

What's in the package?

- Nova3 Studio condenser microphone
- Shock Mount
- Pop shield
- Metal Case



Register your ICON ProAudio product to your personal account

1. Check serial number of your device

Please go to [http:// iconproaudio.com/registration](http://iconproaudio.com/registration) or scan the QR code below.



Input your device's serial number and the other information on the screen. Click "Submit".

A message will pop up showing your device information such as model name and its serial number - Click "Register this device to my account" or if you see any other message, please contact our after-sales service team

2. Log in to your personal account page for existing user or sign up for new user

Existing user: Please log into your personal user page by inputing your user name and password.

New user: Please click "Sign Up" and fill in all the information.

3. Download all useful materials

All your registered devices under your account will show on the page. Each product will be listed along with all its available files such as drivers, firmware, user manual in different languages and bundled software etc. for download. Please make sure you have download the necessary files such as driver before you begin device installation.

Features



The Nova3 large diaphragm condenser microphone is perfect for vocal performance, broadcast, acoustic instruments and amplifiers. It's stylish and affordable as well as offering a high degree of versatility. Switch between polar patterns, cut off unnecessary low frequency rumble at the source with the low cut switch and use the pad to tame high volume sounds, such as a drum kits, loud vocalists or an electric guitar cabinet.

Using extremely high end components like Wima capacitors and Fairchild resistors, the Nova3 combines a beautiful, slick appearance with top grade performance and ultimate versatility.

- High degree of clarity for any voice or instrument applications
- Professional hand-built double sided 34mm large-diaphragm capsule for full, open-sound and unsurpassed audio quality and flexibility
- Switchable polar patterns – figure 8, omni-directional and cardioid
- – 10 dB switchable pad
- Low cut filter
- Ideal as a primary or support microphone for a variety of recording situations
- Pressure-gradient transducer with shock-mounted capsule
- Perfect for vocals and acoustic instruments
- Ultra-rugged construction with electroplated finish
- Top-quality components including a Wima capacitor and Fairchild resistors
- Suspension shock mount and innovative zero-hassle magnetic slip-on pop filter included
- Metal storage carry case

Operating the Nova3

Powering the Nova3 (48V)

The Nova3 is a condenser microphone and therefore needs to be operated by connecting a phantom power supply. Phantom power is standard on most quality mixers, outboard mic pre-amps (MIC pres), and hard disk recorders. If necessary an external phantom power supply can also be used. The Nova3 receives the phantom power directly from a microphone cable when connected to a mixer or other microphone input that includes a phantom supply. The power is actually sent OUT of the microphone INPUT, riding silently along with the audio signal. Most mixers have a switch to engage the phantom power so be sure to check that the phantom power is on.

Setting up the signal level

When connecting the Nova3 to a mixer or recorder input, be sure that the input is at a suitable level. Also, be sure that the 48V phantom power is engaged as explained above. Most mixers and recorders of reasonable quality will offer a microphone input with MIC trim (usually called Trim or Gain) control. The purpose of the MIC trim control is to optimize the amount of good signal to any noise associated with the mixers electronics. A good MIC pre with trim also will have a Peak or Clip LED. To set a good level on the MIC, set the Nova3 up in front of the desired sound source and slowly raise the MIC trim control until you see the Peak LED light up. Then, turn the mix trim control down until the LED does not light any more. On most mixers, the ideal setting is that the trim control is turned up as much as possible without lighting the Peak LED.

Microphone Placement

In order to maximize the sound quality, please pay careful attention to the placement of your Nova3 and how it is positioned for the instrument or vocalist that you are miking. All microphones, especially unidirectional or cardioids microphones, exhibit a phenomenon know as the “proximity effect”. Very simply put, proximity effect is a resulting change in the frequency response of a microphone based on the position of the MIC capsule relative to the sound source. Specifically, when you point a cardioid MIC directly at the sound source (on-axis) you will get the best frequency response, however, when you start pointing the microphone slightly away (off-axis) you will notice the low frequency dropping off and the microphone will start to sound thinner.

For most vocal applications you’ll want to position the microphone directly in front of the artist with the Nova3 in cardioid position. The same may be true for miking instruments. However, you can make some pretty amazing equalization adjustments by slightly changing the angle of the capsule to the sound source. This can be a very

useful technique in capturing the optimum sound of drum set, acoustic guitar, piano or other instruments in a live room or sound stage. Experimentation and experience are the best teachers in getting good sounds, so plug in!

"P"- Popping

P-Poping is that annoying pop that you can get when the microphone diaphragm gets a blast of air from a vocalist pronouncing words with the letter "P" included. (because it is a "plosive" syllable). The Nova3 has a built-in a pop filter which sits inside the net basket (or cradle) to minimize the pop effect.

Simply drop it in - a magnet will secure it's fixture.

Mounting the Nova3

Mount your Nova3 into the provided suspension mount and secure using the screws on the underside. Secure your pop-shield into the special magnetised connector.

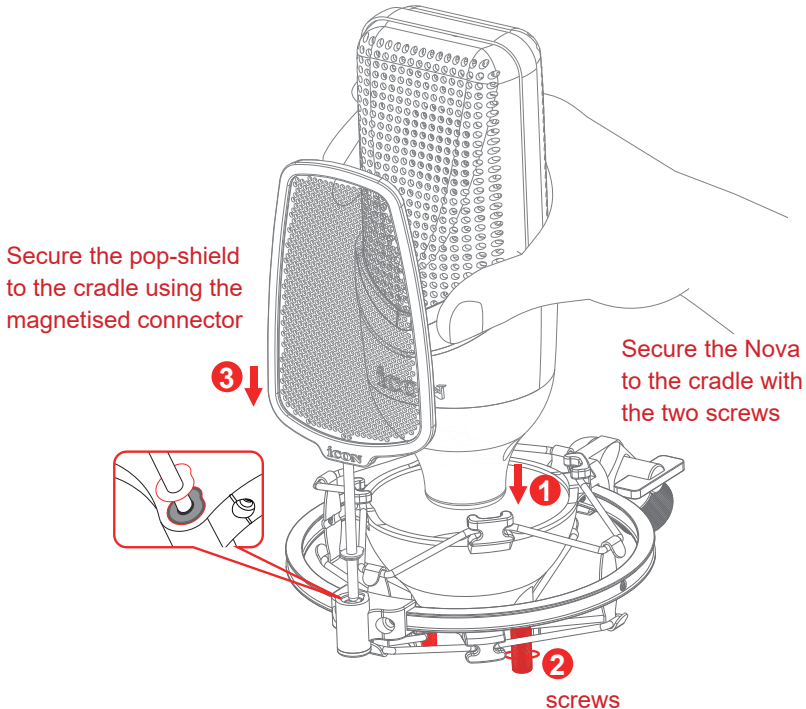

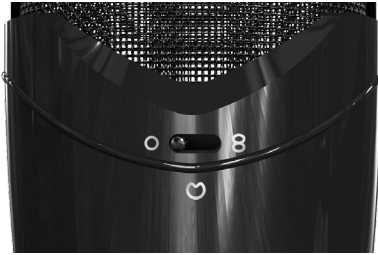

The pattern switch (reverse)

The Omnidirectional pattern is sensitive to sound sources from all directions. Try using this pattern when recording the sound of a room, such as when you want to use the Nova3 as a 'drum room mic' or when recording a wide sound source – such as an orchestra or choir. It is also great when recording a moveable source, such as an instrumentalist who moves around as part of their performance.

The Figure 8 pattern is sensitive to sound sources at the back and front of the microphone – ignoring sounds to the side of the microphone. Try using this pattern when recording a duet, a face-to-face interview, or recording a source when you need to isolate sounds in close proximity and reject sounds to the sides of the microphone – experiment with mic placement to achieve this..

The Cardioid pattern records what the front of the microphone is pointed at, ignoring everything else. It is ideal for vocals and can be used for a wide range of sources including drums, acoustic instruments and guitar cabinets.

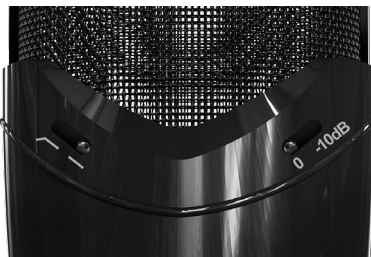

Low cut switch (left)

Cuts low frequency content below 100 Hz. Useful for voices and instruments to reduce low frequency rumble. Think of this as your first EQ move, at the source.

Pad switch (right)

The pad switch reduces the signal from the microphone by -10 dB. This is useful for high volume sources such as guitar cabinets, loud singers or a drum kit. This should be your first choice if you can hear distortion.

Specifications

Frequency response-vary axis

0DB and cardioid

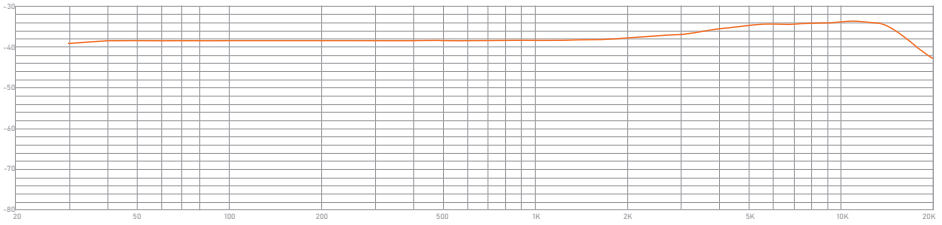

Low cut and cardioid

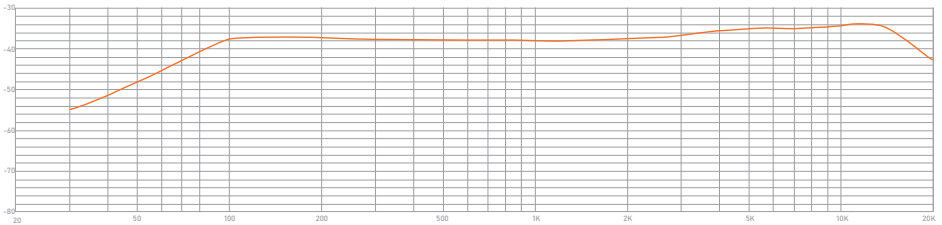
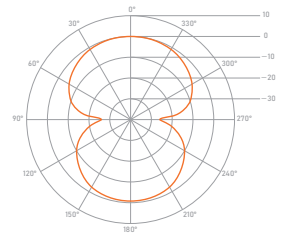
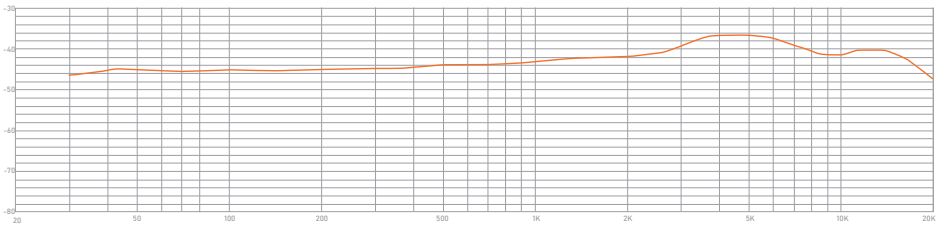
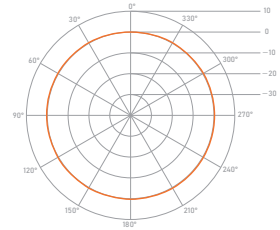
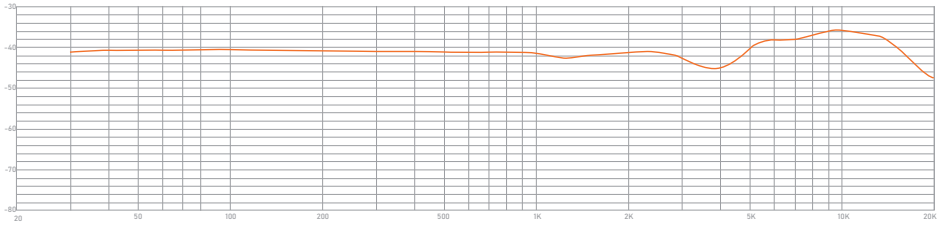

Figure 8 pointing



Omnidirectional



Transducer type.....	electrostatic
Operating principle.....	pressure gradient
The diaphragms active diameter.....	34mm
Frequency range.....	20 Hz to 20 kHz
Polar pattern.....	cardioid, Figure 8
.....	pointing, Omnidirectional
Sensitivity (dB re iV/Pa).....	(-37dBV/Pa)(-40dBV/Pa)
.....	(-38dBV/Pa)
Sensitivity at 1 kHz into 1000 Ω load.....	(-14, 10, 12.5)mV/Pa
Output impedance.....	50 Ω
Rated load impedance.....	1000 Ω
Suggested load impedance.....	>500 Ω
Maximum SPL for 0,5% THD at 1000 Ω load.....	144 dB/ 147dB/ 147dB
S/N Ratio DIN/IEC 651 A-weighten.....	78dB/ 75dB/ 75dB
Dynamic range of the microphone preamplifier.....	128 dB
Phantom powering voltage on pin 2&3 of XLR	+48V (+/-4V)
Current consumption	≤4 mA
Output connector.....	3-pin XLR male
Dimension.....	63mmX60mmX154mm
Weight.....	0.394kg

Services

If your Nova3 needs servicing, follow these instructions.

Check our online Help Center at <http://support.iconproaudio.com>, for information, knowledge, and downloads such as:

1. FAQ
2. Download
3. Product Registration
4. Video Tutorials

Very often you will find solutions on these pages. If you don't find a solution, create a support ticket at our online Help Center at the link below, and our technical support team will assist you as soon as we can.

Navigate to <http://support.iconproaudio.com> and then sign in to submit a ticket. Once you have submitted an inquiry ticket, our support team will assist you to resolve the problem with your ICON ProAudio device as soon as possible.

To send defective products for service:

1. Ensure the problem is not related to operation error or external system devices.
2. Keep this owner's manual. We don't need it to repair the unit.
3. Pack the unit in its original packaging including end card and box. This is very important. If you have lost the packaging, please make sure you have packed the unit properly. ICON is not responsible for any damage that occurs due to non-factory packing.
4. Ship to the ICON tech support center or the local return authorization. See our service centers and distributor service points at the link below:

If you are located in US

Send the product to:

North America

Mixware, LLC – U.S. Distributor

3086 W. POST RD.

LAS VEGAS NV 89118

Tel.: (818) 578 4030

Contact: www.mixware.net/help

If you are located in Europe

Send the product to:

Sound Service GmbH

European Headquarter Moriz-

Seeler-Straße3 D-12489 Berlin

Telephone: +49 (0)30 707 130-0

Fax: +49 (0)30 707 130-189

E-Mail: info@sound-service.eu

If you are located in Hong Kong

Send the product to:

ASIA OFFICE:

Unit F, 15/F., Fu Cheung Centre,

No. 5-7 Wong Chuk Yueng Street,

Fotan,

Sha Tin, N.T., Hong Kong.

Tel: (852) 2398 2286

Fax: (852) 2789 3947

Email: info.asia@icon-global.com

5. For additional update information please visit our website at:
www.iconproaudio.com



天猫官方旗舰店



天猫店艾肯旗舰店

抖音号



抖音iCON艾肯

哔哩哔哩



B站iCONProAudio

中国地区用户

微信公众号



微信号iCON-PRO

官方售后QQ



4006311312.114.qq.com

Twitter



www.twitter.com/iconproaudio

Instagram



www.instagram.com/iconproaudio

Facebook



www.facebook.com/iconproaudio

Youtube



www.youtube.com/iconproaudio

Website



www.iconproaudio.com

Support



support.iconproaudio.com

Dashboard



iconproaudio.com/dashboard/

www.iconproaudio.com